

SCHAEFER

600



SCHAEFER
600



SCHAEFER
600



SCHAEFER
600



SCHAEFER
600

SCHAEFER
600





SCHAEFER
600



SCHAEFER
600

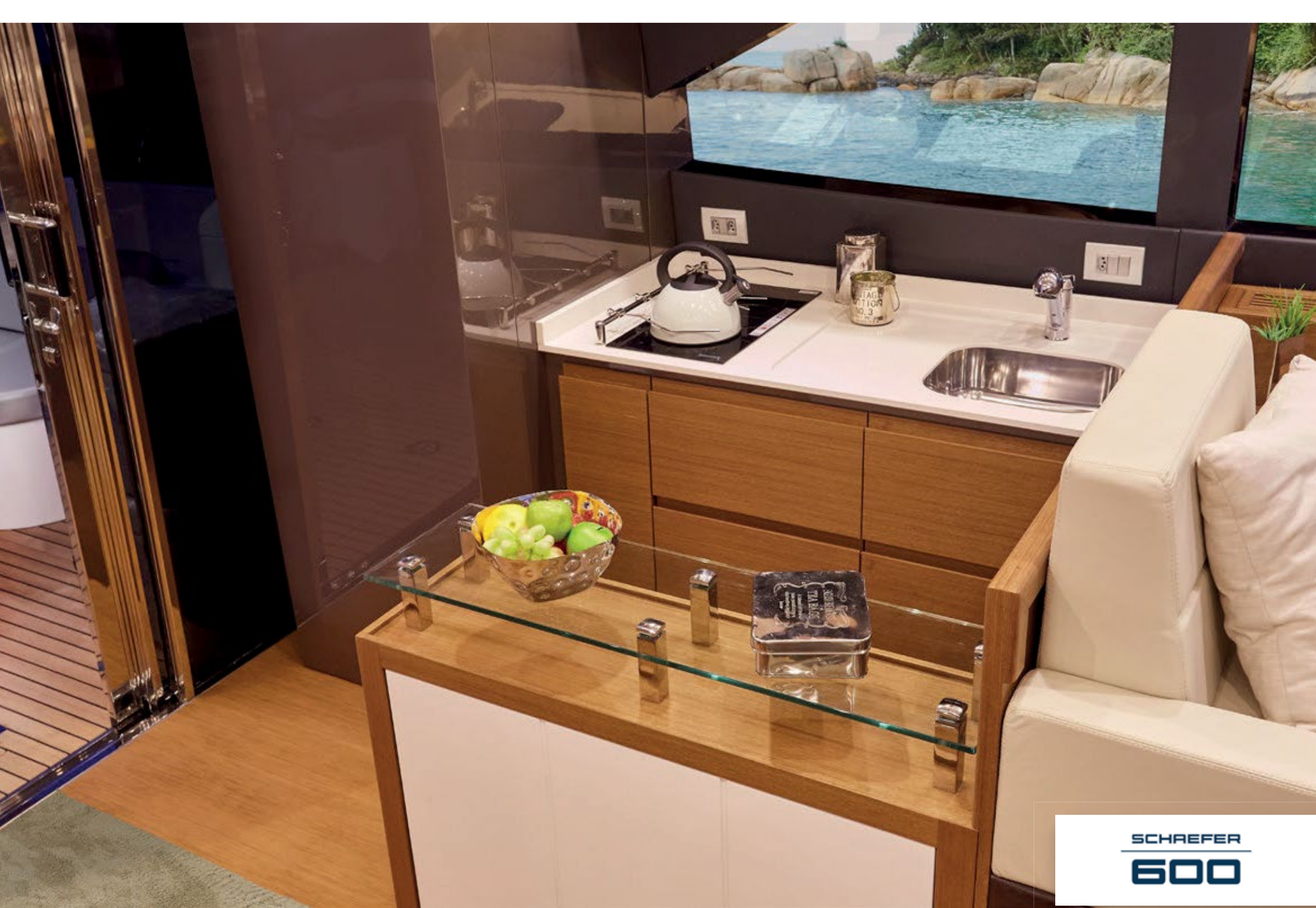

SCHAEFER
600



SCHAEFER
600



SCHAEFER
600



SCHAEFER
600



SCHAEFER
600



SCHAEFER
600



SCHAEFER
600



SCHAEFER
600



SCHAEFER
600



SCHAEFER
600



SCHAEFER
600



SCHAEFER
600

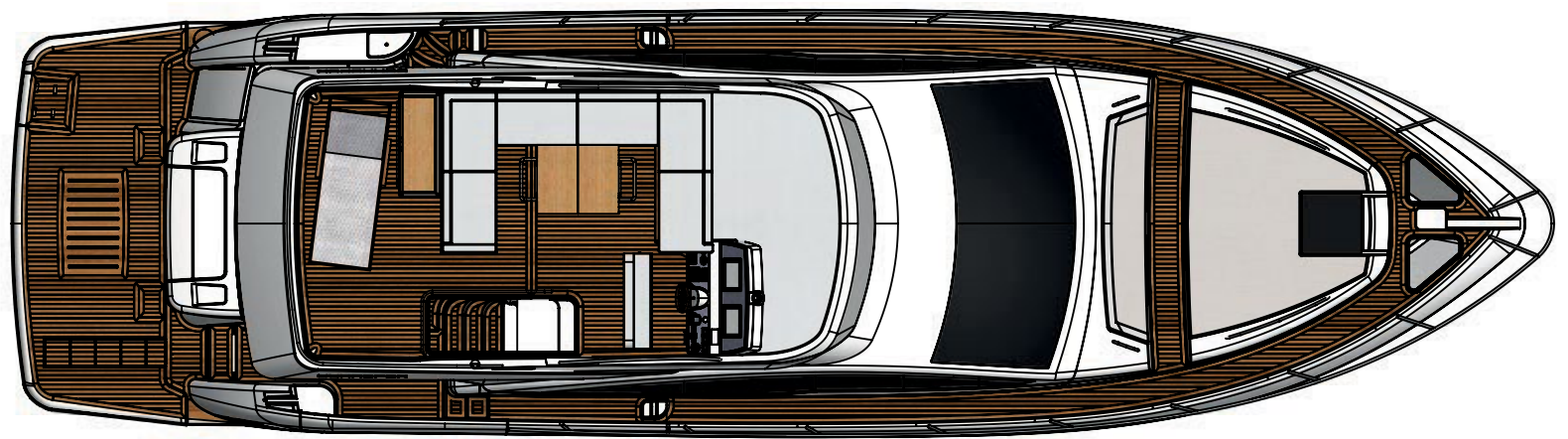

FLYBRIDGE

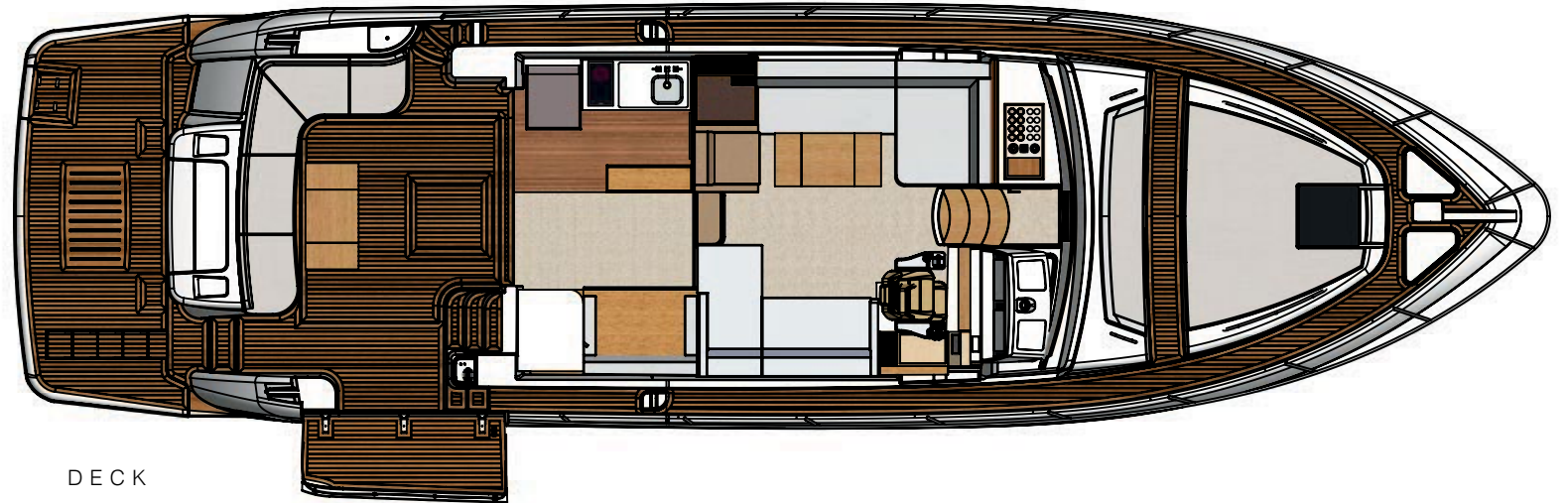

DECK

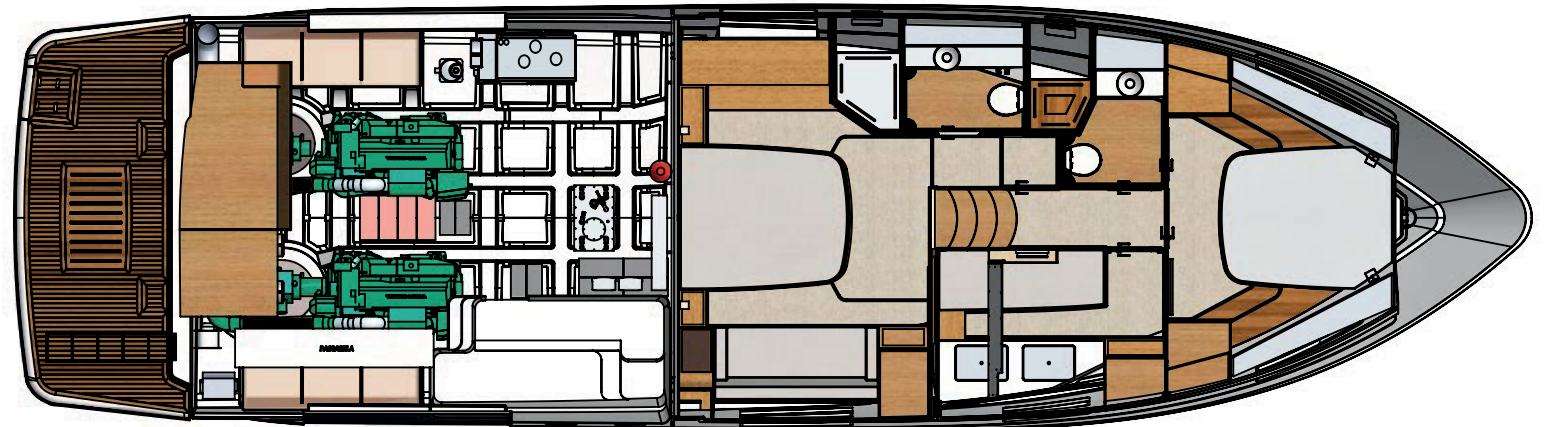

CABINS

SCHAEFER
600



Max. length (including pulpit and platform): 18.08 m (59,.3')

Max beam (including guardrails): 4.96 m (16.3')

Max. draught: 1.45 m (4.8')

Light craft mass: 25,270 kg (55,710 lbs)

Deadrise angle: 14,1 °

Max. speed: 29 knots

Cruising speed*: 24 knots

Fuel consumption at cruising speed: 182 L/h (48 gal/h)

Range: 189 N.M.

Fresh water capacity: 540 l (143 gal)

Fuel capacity: 2,100 l (555 gal)

Installed gensets: 1 x 17kW

Air draught: 6.87 m (22.5')

count extra 5' for clearance when passing under bridges.

Passenger capacity (day): 18

Passenger capacity (night): 6+2

Designer: Marcio Schaefer

** Tests performed in flat water, without excessive wind, no anti-fouling paint and with clean hull and propellers. The engines used on the test were 2 x Volvo Diesel IPS 800 (D6 625 HP).*

*** The maximum speed and cruising speed data as well as fuel consumption and trip duration depend on the onboard loading conditions, ambient temperature, ambient pressure, fuel line, sea state, current, hull bottom condition and stern drive, axles, propellers. There may still be a variation of 7%.*

V33 - 303 - 365 - 375 - 400 - 510
FLY - 400 - 510 - 600 - 660 - 770 - 25M

schaeferyachts.com

